

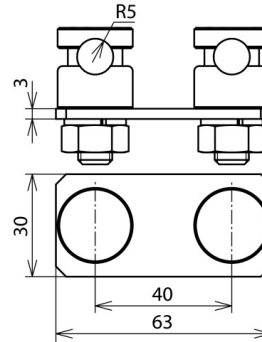

AP 2X6.10 V2A (301 229)



Figure without obligation



Arrangement:

Type	AP 2X6.10 V2A
Part No.	301 229
Material of clamping screw	StSt
Material of clamp	StSt
Clamping range Rd	6-10 mm
Type	+ spring washer
Screw	M10 mm
Material of nut	StSt
Distance of screws	40 mm
Lightning current carrying capability (10/350 µs)	/ *)
Standard	EN 62561-1
Weight	167 g
Customs tariff number (Comb. Nomenclature EU)	85389099
GTIN	4013364101562
PU	1 pc(s)

*)For exact classification, see test certificate.

We reserve the right to introduce changes in performance, configuration and technology, dimensions, weights and materials in the course of technical progress. The figures are shown without obligation.