

D BEB 0 - 77 / EBS 15-03-19 (419 002)

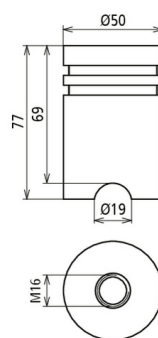

Figure without obligation

Stainless steel earthing bridges

The earthing bridges are designed for earthing, current return circuits and equipotential bonding in railway line applications. The stainless steel earthing bridge ensures this via a defined welding seam to the earthing conductor. This earthing bridge also has a technical approval from DB Netz AG and can be reliably used in planning.

Type	D BEB 0 - 77 / EBS 15-03-19
Part No.	419 002 NEW
Material of connection element	StSt
Material No.	1.4301
Short-circuit current	> 25 kA
Test current	40 kA / 100 ms
Standard	Ril 997.0205A01
Short-circuit current (AC 50 Hz / DC) (1 s; ≤ 300°C)	12.6 kA
Thread	M16
Diameter of connection plate	50 mm
Total height	77 mm
Installation height	69 mm
DB drawing No.	3 Ebs 15.03.19 - 37
Weight	1,05 kg
Customs tariff number (Comb. Nomenclature EU)	85389099
GTIN	4013364439436
PU	1 pc(s)

Note: The D BEB 0 earthing bridges can be made to order up to a height of 100 mm without losing their DB Netz AG approval.

We reserve the right to introduce changes in performance, configuration and technology, dimensions, weights and materials in the course of technical progress. The figures are shown without obligation.