

KFP 25 M12 25 SSM (755 225)

- With threaded pin and self-locking nut



Figure without obligation

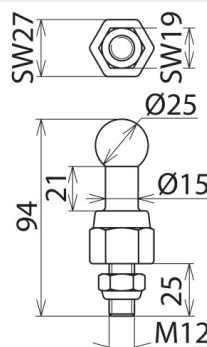

Figure without obligation

Type	KFP 25 M12 25 SSM
Part No.	755 225
Fixed ball point Ø	25 mm
Dimensions	M12 x 25 mm
Wrench size	27 mm
Max. cable cross-section Cu	150 mm ²
Max. short-circuit current I _k 0.5 s	42.0 kA
Max. short-circuit current I _k 1 s	29.6 kA
Standard	EN/IEC 61230 (DIN VDE 0683-100) and based on DIN 48088-1
Material (fixed ball point)	E-Cu/gal Sn
Material (threaded pin)	StSt A2-70
Hexagon nut	DIN 985-M12-8 / gal Zn
Tightening torque	50 ... 65 Nm
Weight	265 g
Customs tariff number (Comb. Nomenclature EU)	85389099
GTIN	4013364004498
PU	1 pc(s)

We reserve the right to introduce changes in performance, configuration and technology, dimensions, weights and materials in the course of technical progress. The figures are shown without obligation.