



KSV 8.12.5 CU (300 017)

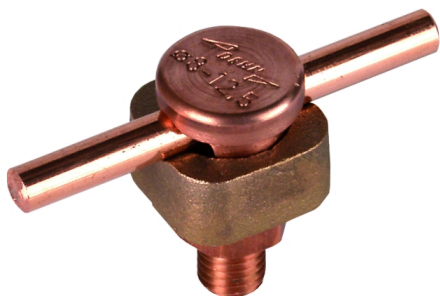
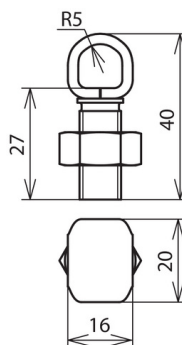

Figure without obligation



Arrangement:

| Type | KSV 8.12.5 CU |
|---|-----------------------|
| Part No. | 300 017 |
| Material of clamping screw | Cu |
| Material of clamp | Gunmetal |
| Clamping range Rd | 8-12.5 mm |
| Connection (single-wire / multi-wire) | 50-95 mm ² |
| Material of nut | Cu |
| Screw | M12 |
| Lightning current carrying capability (10/350 μs) | ^{*)} |
| Standard | EN 62561-1 |
| Weight | 154 g |
| Customs tariff number (Comb. Nomenclature EU) | 85389099 |
| GTIN | 4013364024069 |
| PU | 1 pc(s) |

^{*)}For exact classification, see test certificate.

We reserve the right to introduce changes in performance, configuration and technology, dimensions, weights and materials in the course of technical progress. The figures are shown without obligation.